



Developer :
Riya Manbhari Projects LLP
"Narayani Building" , 1 st Floor
27, Brabourne Road, Kolkata - 700001
Ph : 9830092502, 9830092506
Website : www.riyamanbharigreens.com
E-Mail :info@riyamanbharigreens.com

Site Address :
Riya Manbhari Greens
Howrah Amta Road,
Near Delhi Public School,
Domjur,
Oppsite Jibandeeep Nursing Home,
Howrah.

Marketed By



+91 9830092502
+91 9830092506
email:

sales@riyamanbharigreens.com



+91 9830554444

email: contact@mmgrealty.in



+ 91 0 98310 04006
+ 91 033 4006 4006

email: info@accordrealty.in



+ 91 98311 05222
+ 91 33 6454 3333

email: resi@amitproperties.com

Architect

Raj Agarwal & Associates
8B, Royed Street
2nd floor kolkata 700016

Solicitor

M/s Saha & Ray
7 C, Kiran Shankar Roy Road
Kolkata 700001

Disclaimer

Any part of this brochure, whether in writing or otherwise, is only indicative and no part of the brochure should be treated as a commitment and / or undertaking either from the owner or from the developer.

designed by virtual frame





TYPICAL (1ST TO 7TH) FLOOR PLAN
BLOCK - 6

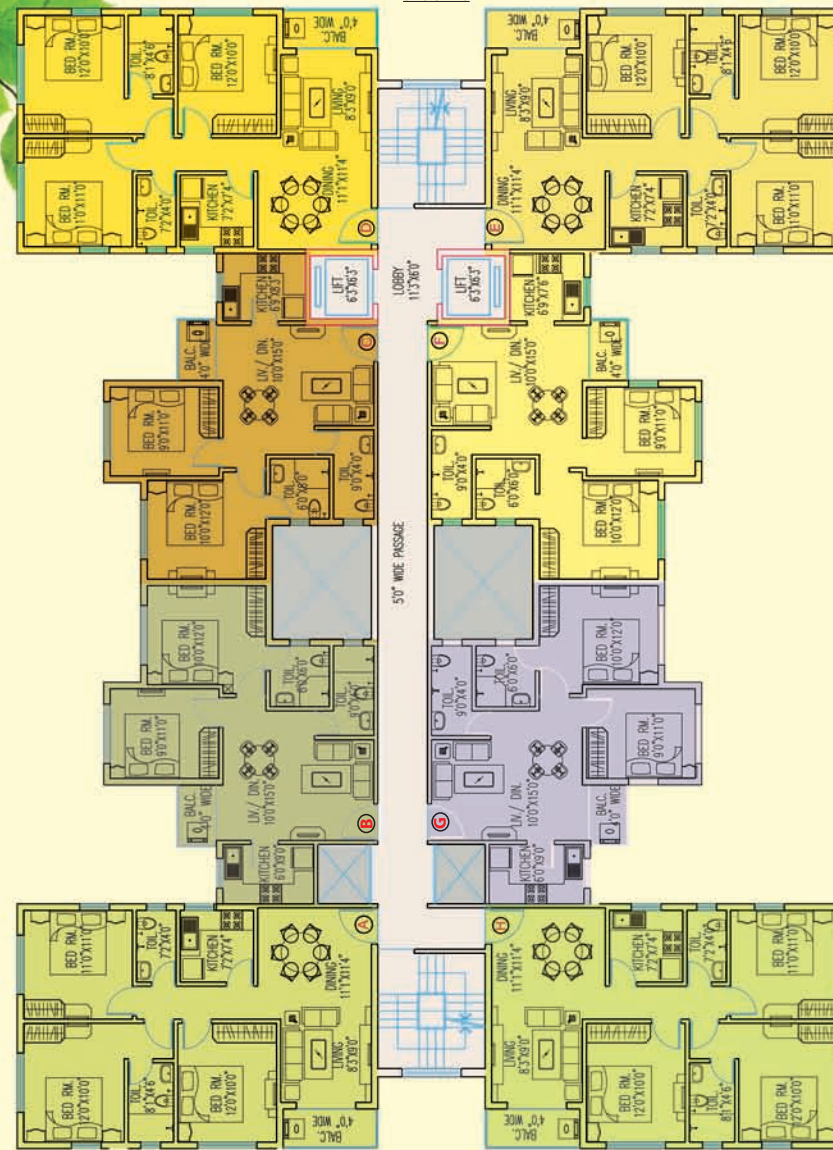

FLAT NO. AREA(SBUA)

- A (3 BHK.) 1133 SQFT
- B (2 BHK.) 823 SQFT
- C (2 BHK.) 829 SQFT
- D (3 BHK.) 1136 SQFT
- E (3 BHK.) 1135 SQFT
- F (2 BHK.) 822 SQFT
- G (2 BHK.) 826 SQFT
- H (3 BHK.) 1133 SQFT

TYPICAL (1ST TO 7TH) FLOOR PLAN
BLOCK - 7

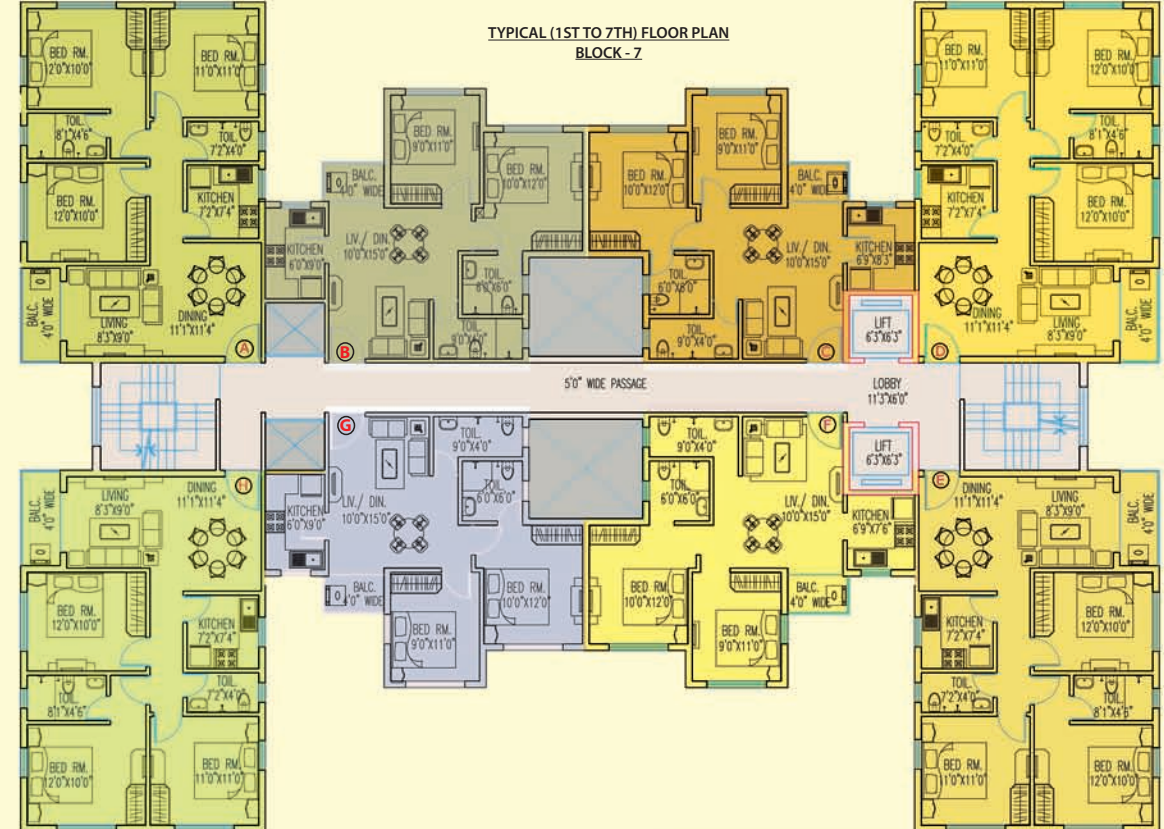

FLAT NO. AREA(SBUA)

- A (3 BHK.) 1133 SQFT
- B (2 BHK.) 823 SQFT
- C (2 BHK.) 829 SQFT
- D (3 BHK.) 1136 SQFT
- E (3 BHK.) 1135 SQFT
- F (2 BHK.) 822 SQFT
- G (2 BHK.) 826 SQFT
- H (3 BHK.) 1133 SQFT

TYPICAL (1ST TO 7TH) FLOOR PLAN
BLOCK - 3

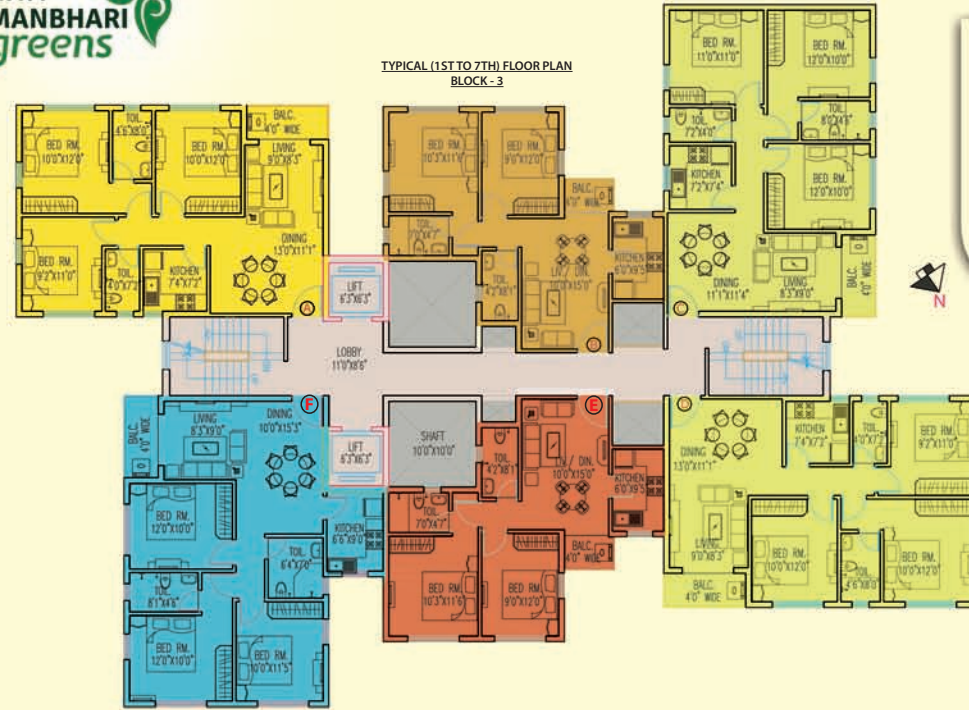

FLAT NO.	AREA(SBUA)
A (3 BHK.)	1136 SQFT
B (2 BHK.)	829 SQFT
C (3 BHK.)	1133 SQFT
D (3 BHK.)	1133 SQFT
E (2 BHK.)	825 SQFT
F (3 BHK.)	1182 SQFT

Floor Plan

TYPICAL (1ST TO 7TH) FLOOR PLAN
BLOCK - 2

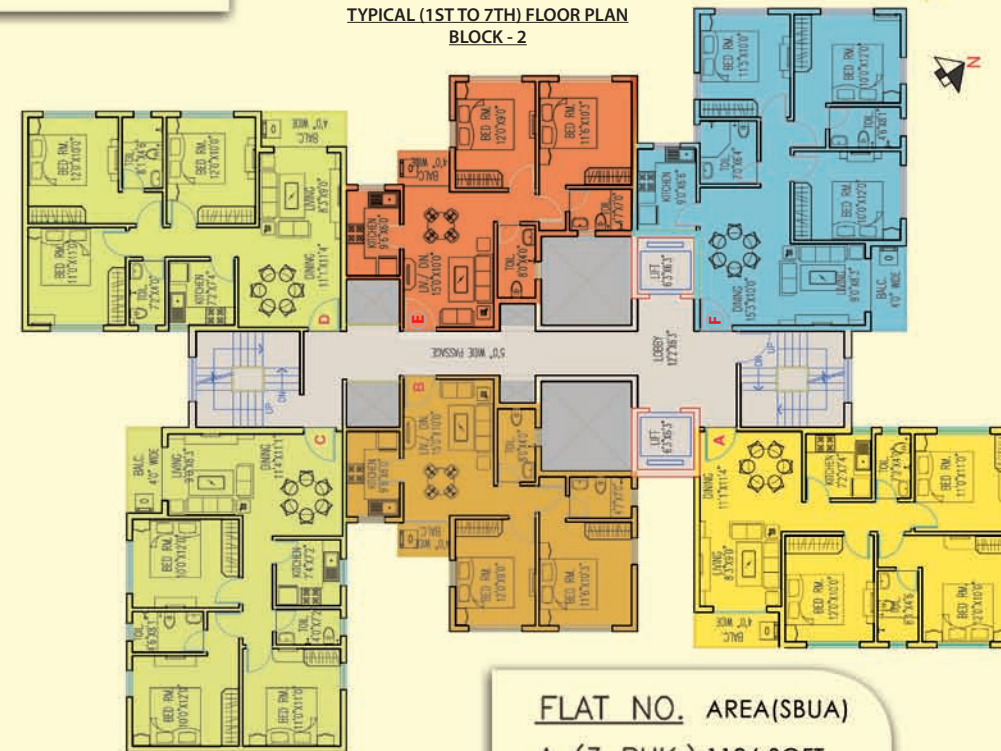

FLAT NO.	AREA(SBUA)
A (3 BHK.)	1136 SQFT
B (2 BHK.)	829 SQFT
C (3 BHK.)	1133 SQFT
D (3 BHK.)	1133 SQFT
E (2 BHK.)	825 SQFT
F (3 BHK.)	1182 SQFT

TYPICAL (1ST TO 7TH) FLOOR PLAN
BLOCK - 1, 4, 5

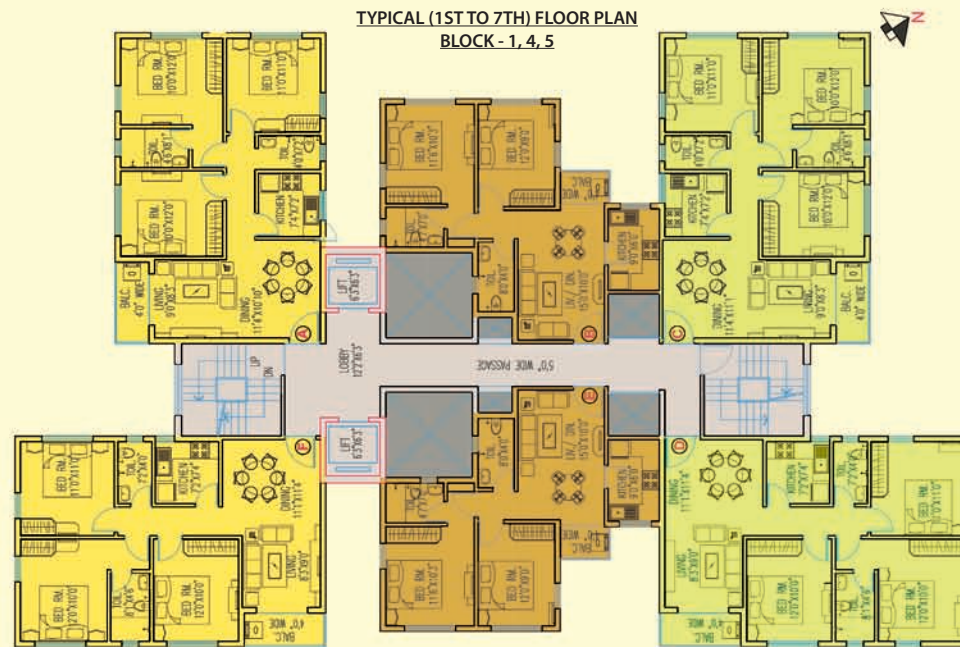

FLAT NO.	AREA(SBUA)
A (3 BHK.)	1136 SQFT
B (2 BHK.)	829 SQFT
C (3 BHK.)	1133 SQFT
D (3 BHK.)	1133 SQFT
E (2 BHK.)	829 SQFT
F (3 BHK.)	1136 SQFT



Location

Riya Manbhari Greens is locationally perfect for those who want to live in harmony with nature without compromising access to schools, hospitals and other lifestyle necessities. (Built barely half an hour from the world famous Howrah Station and airport also, 40 minutes from Park Street. Riya Manbhari Greens could hardly have been built in an more considerate place. One that promises to make each day a glittering miracle of comfort and convenience.

- 0 min DPS Howrah
- 10 mins Salap More/ Bombay Road
- 20 mins Avani Riverside Mall
- 30 mins Dalhousie, Howrah Station & Airport
- 35 mins Howrah AC Market
- 40 mins Salkia
- 40 mins Burrabazar, Kolkata
- 40 mins Alipore/New Alipore
- 40 mins Park Street



Common Amenities

- Well decorated lobby.
- Outdoor play area / Badminton Court.
- Doctor's and visitor's car parking.
- 24 hrs water supply.
- 24 hrs security service.
- Modern Firefighting system.
- Water treatment plant.
- Rain water harvesting.
- Sewage treatment plan.
- Common toilet for staff.
- Manicured lush green garden.
- Separate children's play area.
- Temple.
- 24x7 generator backup for common area and services.
- 24X7 Generator backup in flats*.
- Intercom network.
- Provision for cable TV and broadband infrastructure.
- Adda zone.
- Space for senior citizen entertainment.
- Decorated roof.
- Jogging track.
- Illumination for compound and street lighting.
- Necessary illumination in all lobbies, staircases and common areas.
- Lift of reputed make.
- Stairs and floor lobbies in stone/ tiles/ marble.
- Common area Surveillance with CCTV including ground floor lobby.
- Weather proof with latest non-fading exterior finish.

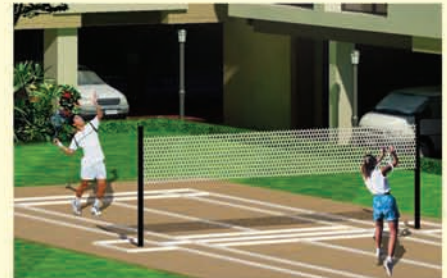

*at extra cost



RIYA
MANBHARI
greens

Home... Close to Nature

Club Amenities

- Well equipped AC Gymnasium.
- Indoor games
Table tennis,
Carom,
Card's room,
Pool and Chess.
- Indoor Children's play area.
- Yoga and Meditation Room.
- Home Theatre.
- Swimming Pool.
- Kids Pool.
- Library.
- Air Conditioned community hall.



Internal & External Specification

Structure:

- Earthquake resistant RCC framed structure with infill bricks wall.

Flooring:

- Bedrooms, Living & Dining - Vitrified tiles.

Wall Finish:

- Interior-Plaster of Paris.
- Exterior- High quality weather proof Cement/textured paint.

Kitchen:

- Ceramic tiled floor.
- Granite Counter.
- Stainless steel sink.
- Dado of ceramic tiles upto 2 feet above the counter.
- Electrical point for refrigerator, water filter, exhaust fan, microwave oven.

Toilet:

- Anti skid ceramic tiled floor.
- Dado of Ceramic tiles on the wall upto door heights.
- White sanitary ware of a reputed make.
- CP fittings of reputed make.
- Electrical point for geyser.
- Plumbing provision for hot/cold water lines.

Doors & Windows

- Tough timber frames and solid-core flush shutter.
- Entrance- laminated flush doors.
- Entrance door fittings-night latch with eyepiece and handle.
- Internal bedrooms-flush door enamel painted with mortise lock.
- Toilet-doors laminated inside and enamel painted outside.
- Windows aluminium sliding /casement with fully glazed shutters.

Electricals:

- Modular switches of reputed make.
- AC point in master bedroom and provision for other bedrooms, Living/ Dining.
- Necessary electrical points with switches in all bedrooms, living/dining, kitchen and Toilets.
- Cable TV conduiting in living/dining and master bedroom.
- Telephone line in living/dining.
- Concealed copper wiring with Central MCB of reputed make.
- Door bell point at entrance door.
- The latest modular switches and miniature circuit breaks, TV socket and Broadband point.

